



10 St Marys Close

Plympton, Plymouth, PL7 4QJ

£630 PCM



A lovely ground floor flat in a popular convenient part of Plympton with accommodation briefly comprising living room, kitchen, 2 bedrooms & bathroom. Allocated parking. Use of communal garden. Strictly no pets or smoking. Double-glazing & gas central heating.



**10 ST MARYS CLOSE, PLYMPTON, PLYMOUTH PL7 4QJ
Accommodation (Accommodation)**

Communal entrance with access through the part-glazed wooden entrance door leading into the hallway.

HALLWAY

Built-in storage cupboard. Door to the bathroom.

BATHROOM 7'9" x 5'6" (2.36 x 1.68)

Coloured suite comprising panel bath with shower unit and spray attachment over and tiled area surround, pedestal wash handbasin and low-level toilet. Built-in extractor fan.

BEDROOM TWO 11'4" x 8'7" (3.45 x 2.62)

Double-glazed window to the rear.

BEDROOM ONE 11'3" x 11'0" at its widest point (3.43 x 3.35 at its widest point)

Double-glazed window to the rear.

LOUNGE 14'9" x 11'0" at its widest points (4.50 x 3.35 at its widest points)

Double-glazed box window to the front. Opening leading into the kitchen.

KITCHEN 7'10" x 7'6" (2.39 x 2.29)

Double-glazed window to the front. Series of matching eye-level and base units with roll-edged work surfaces. Inset single-drainer sink unit with mixer tap. Space and plumbing for washing machine. Built-in 4-ring gas hob with electric oven and grill to the side. Space for under-counter fridge and freezer. Wall-mounted gas boiler.

OUTSIDE

Allocated parking space adjacent to the building. Communal garden to the far end of the building with areas laid to lawn and shrubs including a patio and washing line.

Area Map



Floor Plans

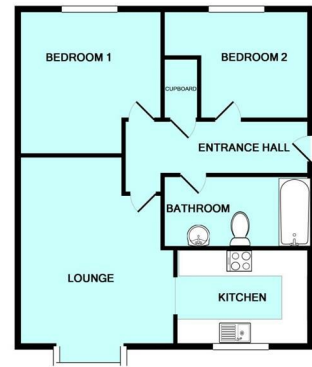

Energy Efficiency Graph

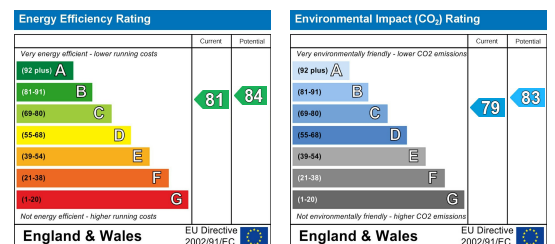

These particulars, whilst believed to be accurate are set out as a general outline only for guidance and do not constitute any part of an offer or contract. Intending purchasers should not rely on them as statements of representation of fact, but must satisfy themselves by inspection or otherwise as to their accuracy. No person in this firm's employment has the authority to make or give any representation or warranty in respect of the property.